

Ball Point Wrenches

For Metal

AIR NIPPER

No.8300BP Ball Point Wrench

Code No.	Size H	mm	mm	Package size (mm)	Inner ctn. (pcs.)	JAN (4907587)
143917	1.5	16	79	160×45×5	10	025142
143918	2	17	86	160×45×5	10	025159
143919	2.5	18	94	200×60×8	10	025166
143920	3	20	101	200×60×8	10	025173
143921	4	25	110	200×60×8	10	025180
143922	5	28	120	200×60×8	10	025197
143923	6	32	133	200×60×8	10	025203
143924	8	36	154	235×75×14	5	025210
143925	10	40	172	235×75×14	5	025227

No.8300BP-L Ball Point Wrench (Long Type)

Code No.	Size H	mm	mm	Package size (mm)	Inner ctn. (pcs.)	JAN (4907587)
143927	1.5	16	79	160×45×5	10	025241
143928	2	17	95	200×60×8	10	025258
143929	2.5	18	110	200×60×8	10	025265
143930	3	20	126	200×60×8	10	025272
143931	4	25	142	200×60×8	10	025289
143932	5	28	160	235×75×14	5	025296
143933	6	32	180	235×75×14	5	025302
143934	8	36	200	280×65×14	5	025319
143935	10	40	224	350×75×14	5	025326
143936	12	45	250	350×110×12*	30	025333
143937	14	55	280	350×110×14*	30	025340
143938	17	60	320	400×130×17*	20	025357
143939	19	70	360	400×130×19*	20	025364

*Supplied in a plastic bag

No.8309BP Ball Point Wrench 9-pc. set

Code No.	Set content
143926	H 1.5, 2, 2.5, 3, 4, 5, 6, 8, 10 mm

Accessory	Package size (mm)	Inner ctn. (sets)	JAN (4907587)
Holder	245×105×27	5	025234

No.8309BP-L Ball Point Wrench (Long Type) 9-pc. set

Code No.	Set content
143940	H 1.5, 2, 2.5, 3, 4, 5, 6, 8, 10 mm

Accessory	Package size (mm)	Inner ctn. (sets)	JAN (4907587)
Holder	295×105×27	10	025371

⚠ Cautions

- Do not touch the blade. ●Always wear protective goggles and earplugs when working with the product. ●When installing or replacing blades or nippers, be sure to shut off the power source. ●Do not use the product if any abnormality such as cracks, chipping, abrasion, or deformation is found. ●Do not use the product in which electricity is running. ●The product may cause vibration. ●Do not modify the product.

VESSEL Co., Inc.

17-25, Fukae-Kita 2-chome, Higashinari-ku, Osaka 537-0001 JAPAN
Tel: +81(0)6 6976 7778 Fax: +81 (0)6 6972 9441
URL: www.vessel.co.jp/english E-mail: export@vessel.co.jp

VESSEL EUROPE

contact@vessel-europe.com
www.vessel-europe.com

Distributed by

24000000.00

●Specifications, dimensions, and others may be subject to change without prior notice.

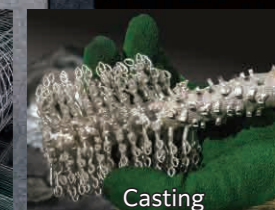
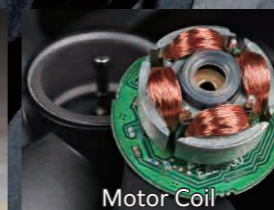

Solutions with Air Nippers

VESSEL has solved users' problems. Here are some examples of our solutions.

Problem #1

Cutting edges are bent due to lack of strength.
Workpiece: Copper wire
Blade that was used: Blade for metal (carbide tipped)

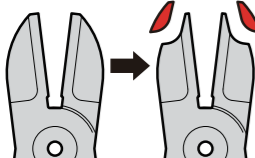

Causes: Since the blade tip had to be thin for insert into the equipment, the standard blade was grinded by the user to make it thinner. As a result, strength of the blade tip was reduced, which caused its bending and misalignment of the cutting edges.

Our Solutions

Custom-made thin tip blade
Nipper: GT-NWS20
Custom-made blade: NW20BJ[***]

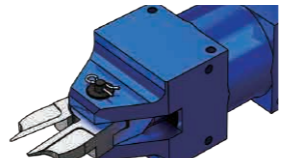

We have designed a blade to meet the customer's requirements by asking about specifications of the workpiece and restrictions around the equipment. Some standard blades can be additionally machined to be thinner, but in this case it is necessary to beware the blade tip strength.

Problem #2

Need to retain the copper wire after cutting.
Workpiece: Copper wire 2.8~4.5φ
Blade that was used: Commercially available robotic hand air chuck



Causes: A non-slip chuck jaws will scratch the enameled coating of the copper wire when they grip it. With a straight chuck, the copper wire will be displaced and scratched.

Our Solutions

Custom-made wire retaining blade
Nipper: GT-NS20
Custom-made blade: N20DI[***]



We designed a special retaining blade with an "hollow" that matches the wire diameter. Multiple shapes were designed according to various sizes of the wire. The place where the wire comes in contact is chamfered, and the retaining force is adjusted by a decompression valve so as not to crush the wire.

Problem #3

When cutting brass material, there is a cutting residue.
Workpiece: Brass hoop material (4×0.6mm)
Blade that was used: Blade for metal

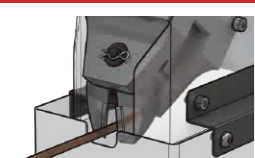

Causes: Used to use the carbide tipped blade and the NS30 nipper. The nipping blade sometimes did not cut fully the material, leaving some that was not cut, because it is soft and thin rather than because of the capability of the nipper itself.

Our Solutions

Custom-made scissor blade with carbide chip
Custom-made nipper: GT-NS20
Blade: N20VHAB[***]



Scissors-shaped blade is custom-made to meet the application so as to cut the material while the cutting edges slide perfectly, and to prevent the wire material from remaining between the cutting edges. The model selection for nippers was reviewed, which reduced the weight of the whole equipment.

Problem #4

Equipment does not have enough space to have a nipper in it.
Workpiece: Copper wire
Blade that was used: N3BJ

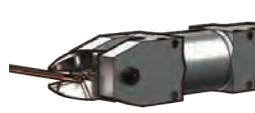

Causes: Since this is for application to cut thin wires, a small nipper is chosen, but actually it cannot be installed because even such a small type interrupts the equipment.

Our Solutions

Side opening blade
Nipper: GT-NS3
Blade: N3BMBL



By using the side opening blade, the nipper can now be placed on the equipment without problems. If there is a space for the GT-NF05, the blade NY05RBJB can be used.

How to choose a nipper

(1) Material and size of the item to cut
Check the detail of the material such as copper wire, steel wire, pipe, band iron etc., and its outer diameter. As for rectangular item, calculate the nipper/blade model from its cross-section.

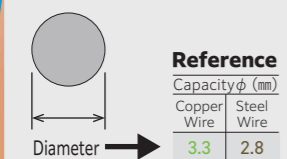

Reference	
Capacity φ (mm)	
Copper Wire	Steel Wire
3.3	2.8

(2) Nipper selection
Choose a nipper that is suitable for the required capacity that is estimated from the material and the diameter. Also, choose the nipper type (square, round, horizontal, or double-action) in consideration of equipment and the required function.

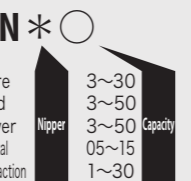
No. GT-N * 

NS : Square 3~30
NR : Round 3~50
NL : w/Lever 3~50
NF : Horizontal 05~15
NW% : Double-action 1~30

(3) Blade selection
Choose a blade that matches the selected nipper. Confirm the blade shape and necessity of carbide, taking into consideration installation in equipment and the expected durability of the blade.

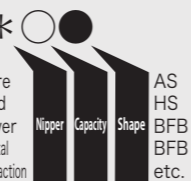
No. N * 

N : Square AS
: Round HS
: w/Lever BFB
NY : Horizontal BFB
NW : Double-action etc.

(4) Before order
We may cut your item for trial. This is recommended to confirm the cutting performance and the cut surface quality. Contact us or the nearest distributor.

(5) Custom-made blades
In case that our standard blades don't match your application, we may design a custom-made blade and quote from 1 piece. Contact us or the nearest distributor.

ADV Series

Pressurized force is increased by 20%.
Recommended to make equipment lighter and smaller.
Compared to the existing model, the 20 type is about 20% more powerful. This has been realized by review of the internal structure and by the new design of the piston and the inside diameter.

Dimensions are same as the existing model.
It is easy to replace the existing model with this new product.
Corresponding to the trend of hardening of the resin products and the larger diameter of the gate, without changing the current jig.

The blade that you have for the exiting model can be used.
The standard blades can be used as the replacement blade, as long as the nipper has the same capacity.

Note: Since the internal structure of this new nipper is different from the existing model, parts are not interchangeable between them. Also, some custom-made blades may not perform as sufficiently as intended.

Booster unit also available.
Dedicated option for the demand of more powerful cutting force. By attaching the booster to the ADV series, the pressurized force is even further increased by about 20%.

Scale is a convenient reference when using with a stand.
The NR series has the scale that is convenient when using with a stand.

Recommended to the following cases:
▶ You want to make the nipper as light as possible without using a pressure booster unit.
▶ The cutting capacity of the current model (NR20, NS20, NR30, NS30) is a little insufficient.
▶ The upper capacity nipper type would be appropriate, but could not be used due to space limitations.
▶ The cutting capacity is sufficient, but the air pressure needs to be lowered.
▶ Applications that require pressurization, such as crimping, punching, bending, etc.

Air Nipper Square Type ADV New

- The nipper that has about 20% more pressurized force than the existing NS20 series and 50% more than the NS30.
- The air inlet position can be adjusted 180 degrees, so it can be changed freely according to the mounting position of the main unit.
- Blades are OPTION.

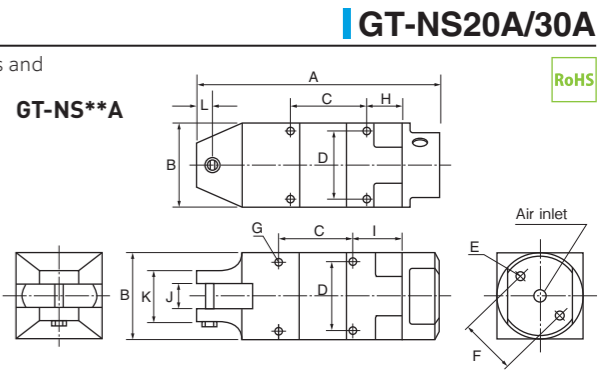

Capacity φ (mm)	Copper Wire	Steel Wire	Code No.	Model No.	Size(mm)												Air Consumption (cm³/str)	Air Pressure (MPa)	Weight (g)	Hose coupling	JAN (4907587)
					A	B	C	D	E	F	G	H	I	J	K	L					
New 3.0	3.0	2.4	360029	GT-NS20A	129	45	40	36	M5 Depth12	30	M4 Depth7	19	24	12	26	9	262	0.4~0.6	366	Rc1/8	035165
New 4.5	4.5	3.0	360030	GT-NS30A	170	56	60	46	M6 Depth12	40	M5 Depth8	20	30	17	36	15	648	0.5~0.6	686	Rc1/8	035172

*The capacity is for reference only, when mounting a standard blade. Subject to the blade type and the material of the product to cut.
*Make sure in advance of the product dimensions for installation to dedicated or automated machine. (Frame outer dimension, screw size, distance between screws, etc.)
*Working air hose inner dia.: 5mm *Overall length and Weight: Accessories not included.

Air Nipper Round Type without Lever, ADV New

- The nipper that has about 20% more pressurized force than the existing NR20 series and 50% more than the NR30.
- The air inlet position can be adjusted 180 degrees, so it can be changed freely according to the mounting position of the main unit.
- Scale is on the lateral side.
- Blades are OPTION.

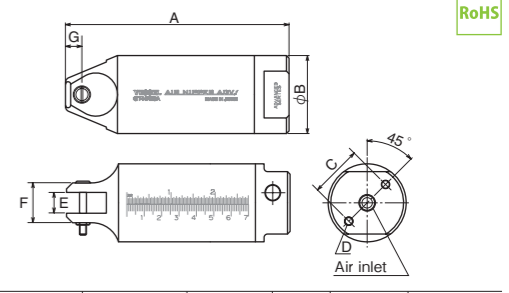

Capacity φ (mm)	Copper Wire	Steel Wire	Code No.	Model No.	Size(mm)							Air Consumption (cm³/str)	Air Pressure (MPa)	Weight (g)	Hose coupling	JAN (4907587)
					A	B	C	D	E	F	G					
New 3.0	3.0	2.4	360027	GT-NR20A	129	45	30	M5 Depth12	12	23	9.5	262	0.4~0.6	269.5	Rc1/8	034700
New 4.5	4.5	3.0	360028	GT-NR30A	170	56	30	M6 Depth12	117	30	10.5	648	0.5~0.6	496.0	Rc1/8	035158

*The capacity is for reference only, when mounting a standard blade. Subject to the blade type and the material of the product to cut.
*Make sure in advance of the product dimensions for installation to dedicated or automated machine. (Frame outer dimension, screw size, distance between screws, etc.)
*Working air hose inner dia.: 5mm *Overall length and Weight: Accessories not included. *Use an optional stand (NR20ST, NR30ST) for installation in equipment.

Booster Unit ADV New

- Booster unit dedicated to the ADV series.
- The booster unit that has about 20% more pressurized force than the existing P series.
- For the application that the originally expected pressurized force cannot be obtained because of the limit of the space and the air pressure.

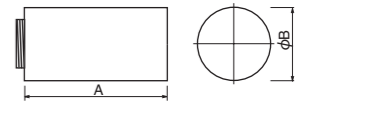
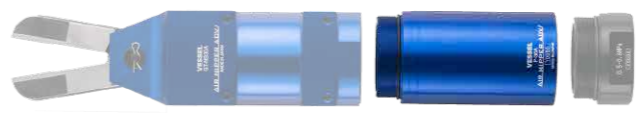

Capacity φ (mm)	Copper Wire	Steel Wire	Code No.	Model No.	Size(mm)		Air Consumption (cm³/str)	Air Pressure (MPa)	Weight (g)	Applicable Nippers (GT-)	JAN (4907587)
					A	B					
New 3.4	3.4	2.6	360055	P-20A	87	45	538	~0.5	164	NS20A/NR20A	034717
New 5.5	5.5	4.5	360056	P-30A	92	56	744	~0.5	266	NS30A/NR30A	035189

*The capacity is for reference only, when mounting a standard blade. Subject to the blade type and the material of the product to cut. The total length and the weight will be the sum of the one of the nipper and the booster unit that is attached.
*Dedicated to the ADV series. Cannot be attached to the existing model (GT-NS/NR).

Clipper Blade (Carbide tipped) New | AFB

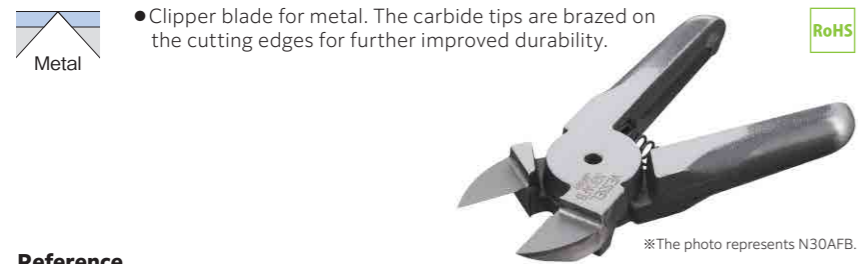

Reference

Capacity (mm) Copper Wire	Steel Wire	Code No.	Model No.	Size (mm)			Weight (g)	Material	Applicable Nippers (GT-)	JAN (4907587)			
				a	b	c							
2.6	2.0	360153	N20AFB	35	12	3	15	11	95	115	Carbide tipped	NS20/NR20/NL20/NS20A/NR20A	035868
3.3	2.8	360163	N30AFB	43	17	4.5	19	11	125	322	Carbide tipped	NS30/NR30/NL30/NS30A/NR30A	035875

Clipper Blade (Carbide tipped) New | BFB



Reference

Capacity (mm) Copper Wire	Steel Wire	Code No.	Model No.	Size (mm)			Weight (g)	Material	Applicable Nippers (GT-)	JAN (4907587)			
				a	b	c(°)							
1.0	0.5	360110	N3BFB	24	7	5.5	13	5	64	28	Carbide tipped	NS3/NR3/NL3	035844
1.6	1.0	360130	N7BFB	27	9	6.5	27	5.5	81	68	Carbide tipped	NS7/NR7/NL7	035851
2.6	2.0	360156	N20BFB	35	12	5	17	8	180	150	Carbide tipped	NS20/NR20/NL20/NS20A/NR20A	372260

Straight Blade - Double Cutting Edge (Carbide tipped) New | AJB

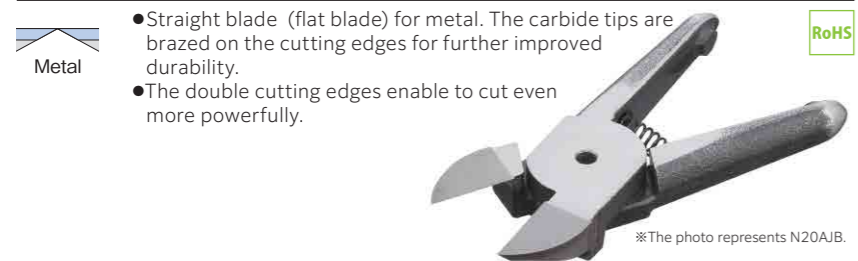

Reference

Capacity (mm) Copper Wire	Steel Wire	Code No.	Model No.	Size (mm)			Weight (g)	Material	Applicable Nippers (GT-)	JAN (4907587)			
				a	b	c							
2.6	2.0	360381	N20AJB	35	12	8	19	11	95	125	Carbide tipped	NS20/NR20/NL20/NS20A/NR20A	378712
3.3	2.8	360162	N30AJB	52	17	7.5	25	14	136	349	Carbide tipped	NS30/NR30/NL30/NS30A/NR30A	035837

Straight Blade - Single Cutting Edge (Carbide tipped) New | BJB

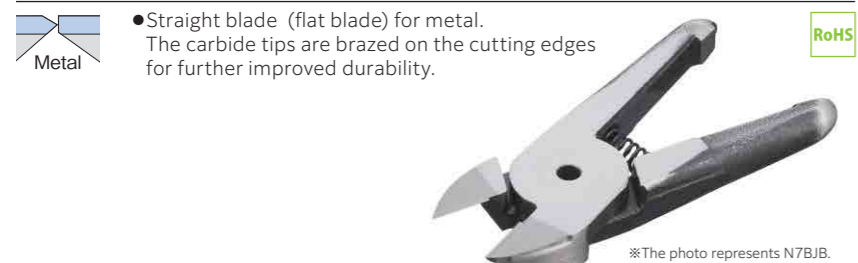

Reference

Capacity (mm) Copper Wire	Steel Wire	Code No.	Model No.	Size (mm)			Weight (g)	Material	Applicable Nippers (GT-)	JAN (4907587)		
				a	b	d Effective Length						
1.0	0.5	360109	N3BJB	24	7	13	5	64	28	Carbide tipped	NS3/NR3/NL3	035813
1.6	1.0	360129	N7BJB	27	9	14	5.5	81	68	Carbide tipped	NS7/NR7/NL7	035820

Straight Blade - Single Cutting Edge | BJ

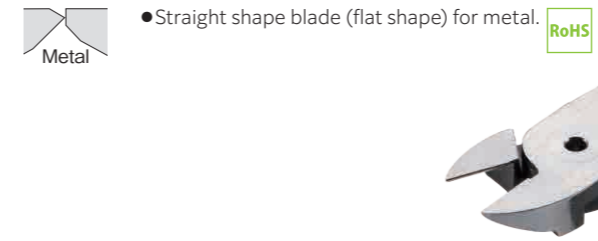

Reference

Capacity (mm) Copper Wire	Steel Wire	Code No.	Model No.	Size (mm)			Weight (g)	Material	Applicable Nippers (GT-)	JAN (4907587)			
				a	b	c(°)							
1.0	0.5	360106	N3BJ	24	7	5.8	13	5	64	35	Special alloy steel	NS3/NR3/NL3	372048
1.0	0.5	360119	N5BJ	24	7	5.8	13	5	64	40	Special alloy steel	NS5/NR5/NL5	378552
1.6	1.0	360128	N7BJ	27	9	7.5	13	5	81	75	Special alloy steel	NS7/NR7/NL7	378569

Side Opening Blade - Single Cutting Edge (Carbide tipped) New | BMB

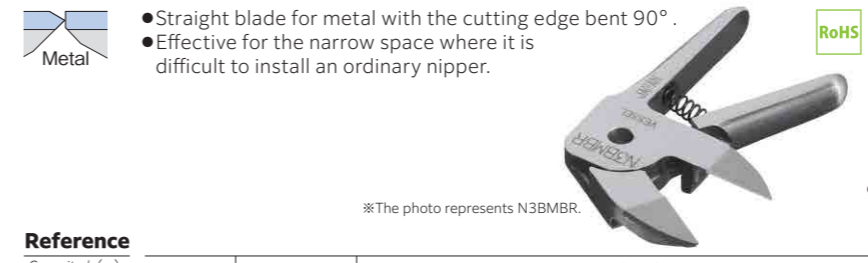

Reference

Capacity (mm) Copper Wire	Steel Wire	Code No.	Model No.	Size (mm)			Weight (g)	Material	Applicable Nippers (GT-)	JAN (4907587)			
				a	b	c(°)							
1.0	0.5	360197	N3BMBL	28	7	4	12	5	13	35.5	Carbide tipped	NS3/NR3/NL3	035882
1.0	0.5	360198	N3BMBR	28	7	4	12	5	13	35.5	Carbide tipped	NS3/NR3/NL3	035899

Standard Blade - Single Cutting Edge | AS

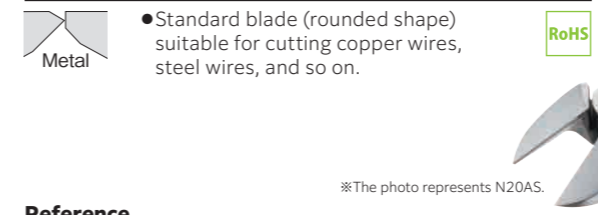

Reference

Capacity (mm) Copper Wire	Steel Wire	Code No.	Model No.	Size (mm)			Weight (g)	Material	Applicable Nippers (GT-)	JAN (4907587)				
				a	b	c(°)								
1.0	0.5	360102	N3AS	24	7	25	12	4	10.5	64	35	Special alloy steel	NS3/NR3/NL3	372024
1.0	0.5	360112	N5AS	24	7	25	12	4	10.5	64	40	Special alloy steel	NS5/NR5/NL5	372079
1.6	1.0	360122	N7AS	27	9	30	13.5	4	12.5	81	80	Special alloy steel	NS7/NR7/NL7	372116
1.8	1.0	360132	N10AS	27	9	30	13.5	5	12.5	91	85	Special alloy steel	NL10	372161
1.8	1.2	360181	N10LAS	35	12	30	20	5	15	89	85	Special alloy steel	NS10L/NR10L	372413
2.3	1.7	360142	N12AS	35	12	30	20	5	15	105	135	Special alloy steel	NL12	372208
2.6	2.0	360151	N20AS	35	12	30	20	9	15	95	140	Special alloy steel	NS20/NR20/NL20/NS20A/NR20A	372239
3.3	2.8	360161	N30AS	43	17	30	25	9	18	127	370	Special alloy steel	NS30/NR30/NL30/NS30A/NR30A	372314

Standard Blade - Single Cutting Edge (HSS tipped) | HS

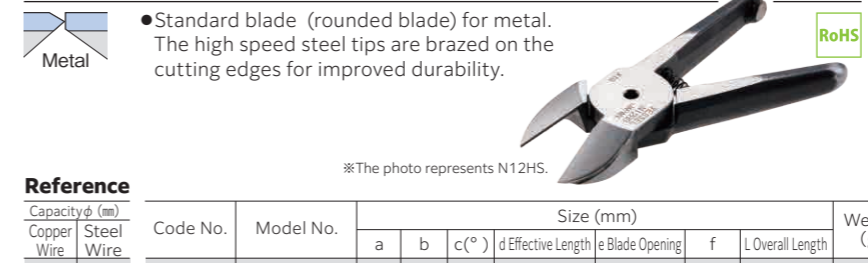

Reference

Capacity (mm) Copper Wire	Steel Wire	Code No.	Model No.	Size (mm)			Weight (g)	Material	Applicable Nippers (GT-)	JAN (4907587)				
				a	b	c(°)								
1.0	0.5	360101	N3HS	24	7	25	12	4	10.5	64	35	HSS tipped	NS3/NR3/NL3	372017
1.0	0.5	360111	N5HS	24	7	25	12	4	10.5	64	40	HSS tipped	NS5/NR5/NL5	372062
1.6	1.0	360121	N7HS	27	9	30	13.5	4	12.5	81	80	HSS tipped	NS7/NR7/NL7	372109
1.8	1.2	360131	N10HS	27	9	30	13.5	5	12.5	91	85	HSS tipped	NL10	372154
2.3	1.7	360141	N12HS	35	12	30	20	5	15	105	135	HSS tipped	NL12	372192

Powerful Cutting Blade - Single Cutting Edge | AG

- Rounded blade for metal. The cutting edges are designed to be thick by shortening the blade effective length.



Capacity (mm) Copper Wire Steel Wire	Code No.	Model No.	Size (mm)					Weight (g)	Material	Applicable Nippers (GT-)	JAN (4907587)		
			a	b	c(°)	d Effective Length	e Blade Opening					f	L Overall Length
2.6 2.0	360159	N20AG	28	12	40	12	7	15	88	135	Special alloy steel	NS20/NR20/NL20/NS20A/NR20A	372291

Powerful Cutting Blade - Single Cutting Edge (HSS tipped) | HS

- Rounded blade for metal. The cutting edges are designed to be thick by shortening the blade effective length. In addition, the high speed steel tips are brazed for improved durability.



Capacity (mm) Copper Wire Steel Wire	Code No.	Model No.	Size (mm)					Weight (g)	Material	Applicable Nippers (GT-)	JAN (4907587)		
			a	b	c(°)	d Effective Length	e Blade Opening					f	L Overall Length
2.6 2.0	360157	N20HS	26	12	40	10	7	13.5	86	135	HSS tipped	NS20/NR20/NL20/NS20A/NR20A	372277

Powerful Cutting Blade - Single Cutting Edge (Carbide tipped) | BBB

- Rounded blade for metal. The cutting edges are designed to be thick by shortening the blade length. In addition, the carbide tips are brazed for further improved durability.
- N50BBB, the double cutting edge type, enables to cut even more powerfully.

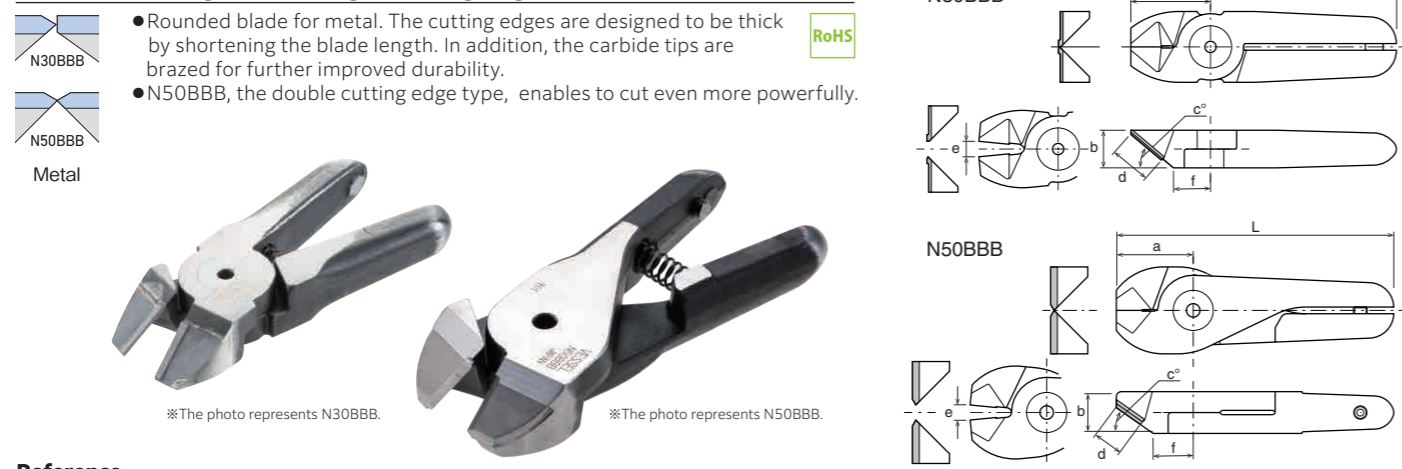

Capacity (mm) Copper Wire Steel Wire	Code No.	Model No.	Size (mm)					Weight (g)	Material	Applicable Nippers (GT-)	JAN (4907587)		
			a	b	c(°)	d Effective Length	e Blade Opening					f	L Overall Length
3.3 2.8	360172	N30BBB	36	17	40	18	7	18	120	364	Carbide tipped	NS30/NR30/NS30A/NR30A/NL30	372383
5.5 4.5	360177	N50BBB	46	25	35	19	9	24	166	955	Carbide tipped	NS50/NR50	372406

Clipper Blade - Double Cutting Edge | AS

- Can cut powerfully with double cutting edges.



Capacity (mm) Copper Wire Steel Wire	Code No.	Model No.	Size (mm)					Weight (g)	Material	Applicable Nippers (GT-)	JAN (4907587)	
			a	b	c(°)	d Effective Length	e Blade Opening					L Overall Length
5.5 4.5	360175	N50AS	60	25	10	30	11	180	950	Special alloy steel	NR50	372390

Type-F Air Nipper

- Compact, lightweight nippers suitable for mounting inside equipment.
- Blades are OPTION.

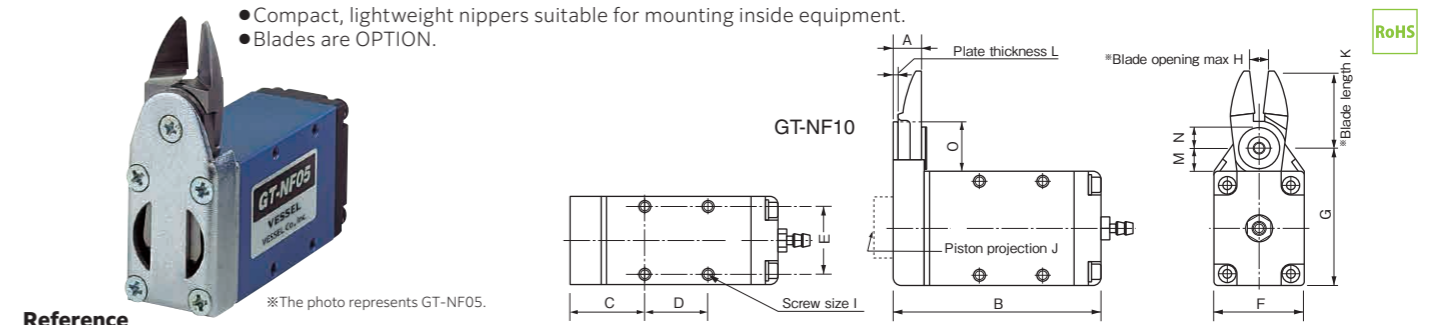

Capacity (mm) Copper Wire Steel Wire	Code No.	Model No.	Size (mm)													Air Consumption (cm ³ /str)	Air Pressure (MPa)	Weight (g)	Hose I/D (mm)	JAN (4907587)		
			A	B	C	D	E	F	G	H	I	J	K	L	M						N	O
1.6 1.0	360606	GT-NF05	8.6	59.9	21.9	17	18	23	39.5	4	M3	1.6	22	1.6	8.4	6.25	16.4	43	0.4~0.5	101	1/DΦ2.5×O/DΦ4	308511
1.7 1.1	360607	GT-NF10	8.8	65.1	23.1	20	22	28	43.5	6	M3.5	1.6	24	1.6	7.4	6.25	15.4	63	0.4~0.5	143	1/DΦ2.5×O/DΦ4	308528
1.8 1.2	360608	GT-NF15	10.2	73	25	25	26	33	48.5	8	M4	2	27	2	7.4	6.25	16.4	128	0.4~0.5	219	1/DΦ2.5×O/DΦ4	308535

※The capacity is for reference only when mounting a standard blade. Subject to the blade type and the material of the product to cut.
※Overall length · Weight: Accessories not included.

Blade Opening Adjustment Plate | WAS

- Optional part for reducing the opening width of the nipper blade.
- Can adjust the width with the screw on the right and left side.

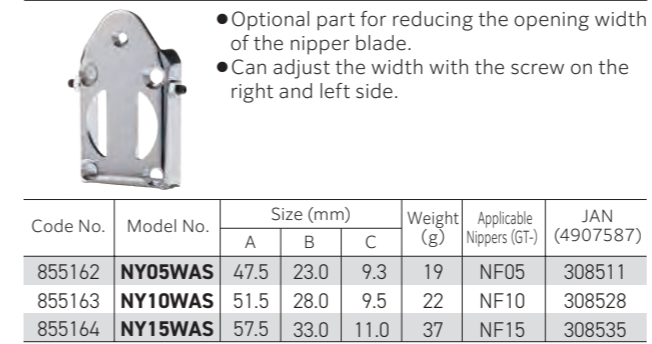

Code No.	Model No.	Size (mm)			Weight (g)	Applicable Nippers (GT-)	JAN (4907587)
		A	B	C			
855162	NY05WAS	47.5	23.0	9.3	19	NF05	308511
855163	NY10WAS	51.5	28.0	9.5	22	NF10	308528
855164	NY15WAS	57.5	33.0	11.0	37	NF15	308535

Blade Spring

- Spring for making the blade open (Optional part)
- Regular replacement is recommended.

Code No.	Model No.	Size (mm)		Applicable Nippers (GT-)	JAN (4907587)
		Outer Dia.φ	Free Length		
859111	Blade Spring	3.8	11	NF05	-
859115	Blade Spring	3.6	16.5	NF10	-
859115	Blade Spring	3.6	16.5	NF15	-

Straight Blade - Single Cutting Edge (Carbide tipped) *New* | RBJB

- Straight shape blade (flat shape) for metal. The carbide tips are brazed on the cutting edges for further improved durability.



Capacity (mm) Copper Wire Steel Wire	Code No.	Model No.	Size (mm)				Weight (g)	Material	Applicable Nippers (GT-)	JAN (4907587)		
			a	b	c(°)	d Effective Length						
New 1.0 0.5	360506	NY03RBJB	21	7	4.5	10.5	3	48	17	Carbide tipped	NY03GR	035660
New 1.6 1.0	360507	NY05RBJB	22	7	5	10.5	4	53	24	Carbide tipped	NF05	035677
New 1.7 1.1	360508	NY10RBJB	24	7.2	5	12	6	57	29	Carbide tipped	NF10	035684
New 1.8 1.2	360509	NY15RBJB	27	8.2	5.5	13	8	65	41	Carbide tipped	NF15	035691
New 2.2 1.6	360510	NY25RBJB	31	10	6	16	9	77	70	Carbide tipped	NY25R/25S	035707

Straight Blade - Single Cutting Edge | RBJ

- Straight blade for easy incorporation into equipment.



Capacity (mm) Copper Wire Steel Wire	Code No.	Model No.	Size (mm)					Weight (g)	Material	Applicable Nippers (GT-)	JAN (4907587)	
			a	b	c	d Effective Length	e Blade Opening					L Overall Length
1.6 1.0	360559	NY05RBJ	22	7	5	11.5	4	53	22	Special alloy steel	NF05	370426

Double Action Air Nipper (Square Type)

- Blade opening and closing is driven by air piston.
- Blades are OPTION.



※The photo represents GT-NWS20.

Reference

Capacity φ (mm) Copper Wire Steel Wire	Code No.	Model No.	Size (mm)											Air Consumption (cm ³ /str)	Air Pressure (MPa)	Weight (g)	Hose I/D (mm)	JAN (4907587)	
			A	B	C	D	E	F	G	H	I	J	K						L
1.0 1.5	360702	GT-NWS1	95	20×18	40	16	M5-P0.8	9	M3 Depth4.5	-	32	5	16	6	95	0.4~0.5	116	I/DΦ2.5×O/DΦ4	309730
1.8 1.2	360706	GT-NWS10	146	36×36	30	28	PT1/8	16	M4 Depth6	64	69	9	23	8	146	0.4~0.5	356	I/DΦ4×O/DΦ6	309778
2.6 2.0	360707	GT-NWS20	176	45×45	40	36	PT1/8	18	M4 Depth8	68.5	73.5	12	26	9.5	165	0.5~0.6	610	I/DΦ4×O/DΦ6	309785
3.3 2.8	360708	GT-NWS30	231	56×56	60	46	PT1/4	24	M5 Depth12	84.5	94.5	17	36	13	230.5	0.5~0.6	1,115	I/DΦ4×O/DΦ6	309891

※The capacity is for reference only when mounting a standard blade. Subject to the blade type and the material of the product to cut.
※Overall length, Weight: Accessories not included.

GT-NWS1/10/20/30

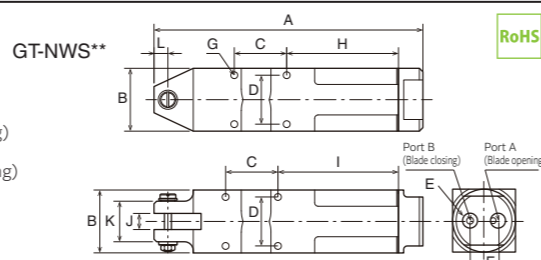

Double Action Air Nipper (Round Type without Lever)

- Blade opening and closing is driven by air piston.
- Blades are OPTION.



※The photo represents GT-NWR20.

Reference

Capacity φ (mm) Copper Wire Steel Wire	Code No.	Model No.	Size (mm)						Air Consumption (cm ³ /str)	Air Pressure (MPa)	Weight (g)	Hose I/D (mm)	JAN (4907587)	
			A	B	E	F	J	K						L
1.8 1.2	360710	GT-NWR10	154	36	PT1/8	16	9	23	8	146	0.4~0.5	280	I/DΦ4×O/DΦ6	309808
2.6 2.0	360711	GT-NWR20	159.5	45	PT1/8	18	12	26	9.5	165	0.4~0.5	523	I/DΦ4×O/DΦ6	309815
3.3 2.8	360712	GT-NWR30	213.5	56	PT1/4	24	17	36	13	230.5	0.5~0.6	980	I/DΦ4×O/DΦ6	309822

※The capacity is for reference only when mounting a standard blade. Subject to the blade type and the material of the product to cut.
※Overall length, Weight: Accessories not included.

GT-NWR10/20/30

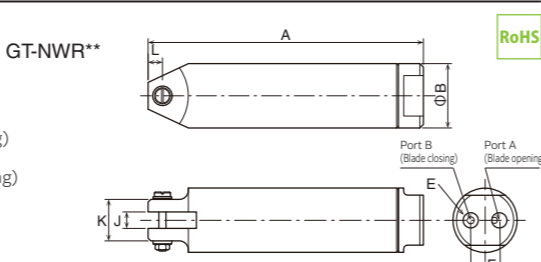

Double Action Straight Blade - Single Cutting Edge (Carbide tipped) *New* BJB

- Straight shape blade (flat shape) for metal. The carbide tips are brazed for further improved durability.

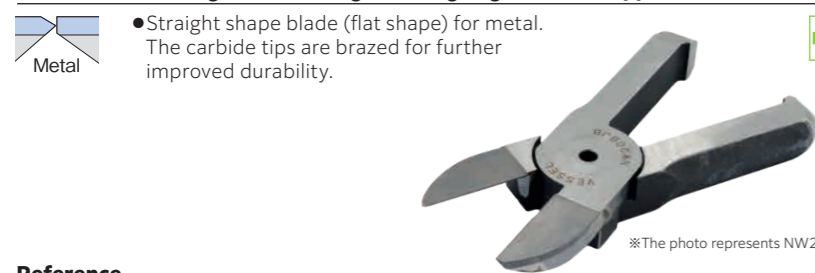

※The photo represents NW20BJB.

Reference

Capacity φ (mm) Copper Wire Steel Wire	Code No.	Model No.	Size (mm)						Weight (g)	Material	Applicable Nippers (GT-)	JAN (4907587)
			a	b	c	d Effective Length	e Blade Opening	L Overall Length				
1.8 1.2	360464	NW10BJB	30	9	6	16.5	5	85	80	Carbide tipped	GT-NWR10/NWS10	035226
2.6 2.0	360465	NW20BJB	40	12	6	24.5	8	100	149	Carbide tipped	GT-NWR20/NWS20	035783

Double Action Straight Blade - Single Cutting Edge

- Straight shape blade (flat shape) for metal.

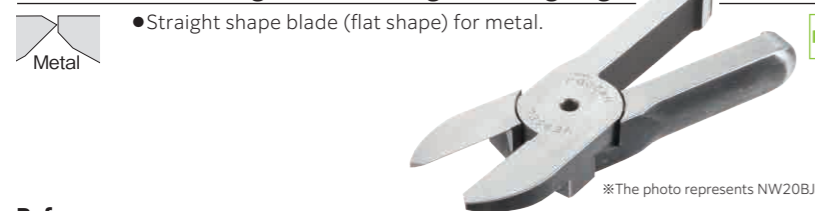

※The photo represents NW20BJ.

Reference

Capacity φ (mm) Copper Wire Steel Wire	Code No.	Model No.	Size (mm)						Weight (g)	Material	Applicable Nippers (GT-)	JAN (4907587)
			a	b	c	d Effective Length	e Blade Opening	L Overall Length				
1.0 0.5	360450	NW1BJ	20	5	3	10.5	3.5	50	16	Special alloy steel	NWS1	370006
1.8 1.2	360453	NW10BJ	30	9	6	14	5	85	76	Special alloy steel	NWR10/NWS10	370709
2.6 2.0	360459	NW20BJ	40	12	6	21.5	8	100	142	Special alloy steel	NWR20/NWS20	370747
3.3 2.8	360460	NW30BJ	55	17	8	29.5	11	140	367	Special alloy steel	NWR30/NWS30	370754

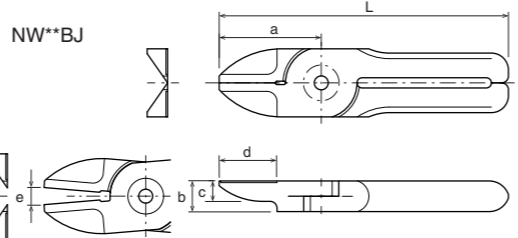
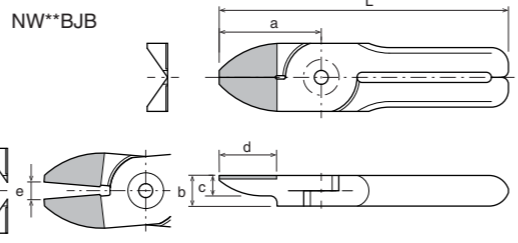

Double Action Air Scissor (Square Type)

- Blade opening and closing is driven by air piston.
- Free from troubles due to the spring breakage because there is no spring part in the nipper body and blade.
- Blades are OPTION.



※The photo represents GT-HWS1.

Reference

Capacity φ (mm) Copper Wire Steel Wire	Code No.	Model No.	Size (mm)											Air Consumption (cm ³ /str)	Air Pressure (MPa)	Weight (g)	Hose I/D (mm)	JAN (4907587)	
			A	B	C	D	E	F	G	H	I	J	K						L
1.0 0.5	360700	GT-HWS1	101	23×20	40	16	M5-P0.8	9	M3 Depth4.5	-	32	5	16	6	45	0.4~0.5	116	I/DΦ2.5×O/DΦ4	309716
1.8 1.2	360713	GT-HWS10	154	36×36	30	28	PT1/8	16	M4 Depth6	64	69	9	23	8	116	0.4~0.6	356	I/DΦ4×O/DΦ6	309747

※The capacity is for reference only when mounting a standard blade. Subject to the blade type and the material of the product to cut.
※Overall length, Weight: Accessories not included.

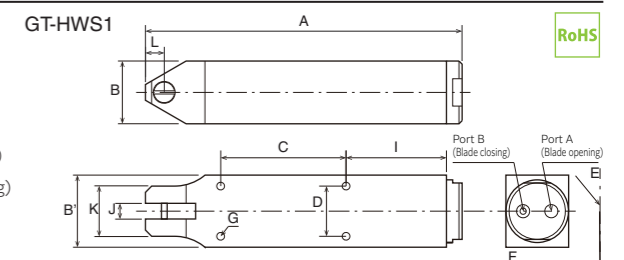

Double Action Air Scissor (Round Type without Lever)

- Blade opening and closing is driven by air piston.
- Free from troubles due to the spring breakage because there is no spring part in the nipper body and blade.
- Blades are OPTION.



※The photo represents GT-HWR1.

Reference

Capacity φ (mm) Copper Wire Steel Wire	Code No.	Model No.	Size (mm)						Air Consumption (cm ³ /str)	Air Pressure (MPa)	Weight (g)	Hose I/D (mm)	JAN (4907587)	
			A	B	E	F	J	K						L
1.0 0.5	360701	GT-HWR1	101	20	M5-P0.8	9	5	16	6	45	0.4~0.5	84	I/DΦ2.5×O/DΦ4	309723
1.8 1.2	360714	GT-HWR10	154	36	PT1/8	16	9	23	8	116	0.4~0.6	295	I/DΦ4×O/DΦ6	309754

※The capacity is for reference only when mounting a standard blade. Subject to the blade type and the material of the product to cut.
※Overall length, Weight: Accessories not included.

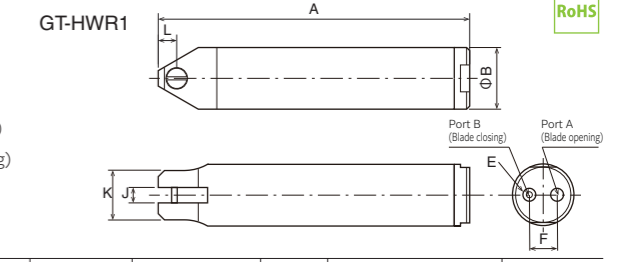

Double Action Scissor Blade J

- Scissor type blade for metal
- The scissor cutting edges overlap and there is less remain of cutting residue.



※The photo represents HW1J.

Reference

Capacity φ (mm) Copper Wire Steel Wire	Code No.	Model No.	Size (mm)					Weight (g)	Material	Applicable Nippers (GT-)	JAN (4907587)
			a	b	d Effective Length	e Blade Opening	L Overall Length				
1.0 0.5	360452	HW1J	25	5.3	17	3	55	16	Special alloy steel	GT-HWR1/HWS1	370013
1.8 1.2	360462	HW10J	40	9.4	28	5	95	76	Special alloy steel	GT-HWR10/HWS10	370020

Air Nipper for Orchid Support Stick

- Includes a cutting position stopper to prevent cutting errors.
- Blades are equipped with urethane covers to prevent the stick from flying off after being cut.

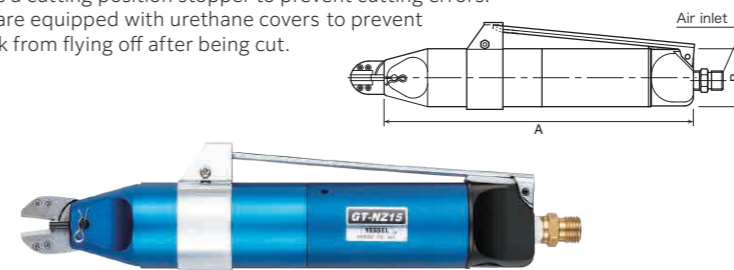

Reference

Capacity φ (mm) Annealing Vinyl Stick	Code No.	Model No.	Size (mm)		Air Pressure (MPa)	Air Pressure (MPa)	Weight (g)	Hose coupling	JAN (4907587)
			A	B					
#10 φ4.2~6	360759	GT-NZ15(w/NZ15AJ)	213.5	40	250	0.65	455	Rc1/4	030504
#8 φ4.2~6	360758	GT-NZ15(w/NZ20AJ)	213.5	40	250	0.65	465	Rc1/4	369888

※High-hardness annealing wire may not be cut
※Overall length · Weight ... Accessories not included.

Blade for the GT-NZ15 INZ

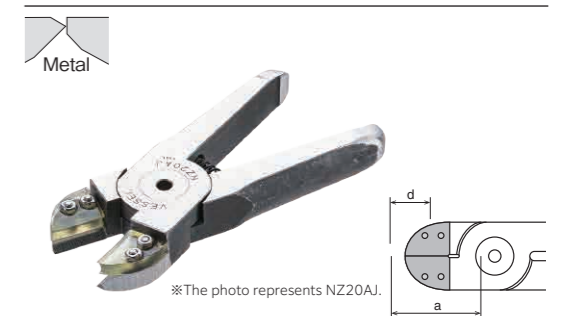

Code No.	Model No.	Size (mm)			Weight (g)	JAN (4907587)
		a	d Effective Length	e Blade Opening		
360504	NZ15AJ	30	15	7.2	132	370013
360505	NZ20AJ	31	15	7.5	142	370020