



AIR TOOLS

www.vessel-europe.com

MADE FOR THE PROFESSIONAL HISTORICAL

1973 Creation in Nagano (formerly Shinano), under the name shinano pneumatic

1985 Name change to SP AIR CORPORATION

2020 Joined the VESSEL Group

COMPETITION

1996 Start of sponsorship of Japan GT Car

1998 Participation in the Le Mans race in France

2000 V8 Supercar sponsorship begins in Australia



SP AIR is a brand of VESSEL Co., Inc.

VESSEL EUROPE : 8 Avenue Johannes Gutenberg, 78310 Maurepas, FRANCE

Tel : +33 (0)1 69 19 17 42 Fax : +33 (0)1 69 19 42 20 contact@vessel-europe.com www.vessel-europe.com



SAFETY STANDARDS

- **Main safety instructions**

We have selected below the most important sources of danger, related to the use of pneumatic devices. These are not exhaustive. For more information, we invite you to consult the user manual of each tool, available at your workplace.

- **Workplace**

Take care to remove anything that could disrupt your work, while using a pneumatic tool (cables, pipes, ropes, etc.).

- **Compressed air**

Compressed air at high pressure is very dangerous.

Never direct the jet of air at yourself or anyone else nearby.

When connecting a pneumatic device, check that the fittings, pipes and seals are working properly.

When changing accessories, always remember to unplug your device and purge it.

Do not exceed the maximum pressure indicated in the manual under any circumstances.

- **Projectiles and dust**

Wearing glasses, a dust mask and work gloves is strongly recommended when using a pneumatic device.

- **Entanglement**

Be very vigilant to anything that is likely to hinder the operation of a rotating part (accessories or floating clothing ...)

- **Vibrations**

In case of repeated or prolonged exposure to vibrations or poor posture, you may experience numbness as well as body tingling.

If the vibrations are too strong you risk a punctual insensitivity of the hands.

Stop the tool and consult a doctor.

- **Noise pollution**

Always use ear protectors.

Excessive noise level can lead to loss of hearing.



SP AIR tools satisfy the requirements of EC Machine Directive (2006/42/EC).

- Measurements according to ISO-2787.
- Noise levels according to ISO-15744.
- Vibration levels according to ISO-8662, ISO-28927.

- Ideal tool for **automotive bodywork, industry and construction**
- **Adjustable head** allowing cutting in the **most difficult accesses**



Model	Rotation al speed (RPM)	Diameter disk (mm)	Length (mm)	Weigh t (kg)	Vibration level (m/s)	Sound level dB(A)	Consumption (m/min)	Power connection	Pressure (Bar)
SP-7231	18 000	75	220	1,2	0,63	90	0,8	1/4"	7

- Perfect for mechanics to **reach difficult places**, the ratchet passes where your hand passes
- Patented **adjustable head for ease of use**
- Recommended use with **adjustable connection** to keep its **small footprint**



- Head 4 positions



- Complementary accessory articulated fitting ref. HY-B40



Model	Training square	Length (mm)	Optimum torque (N.m.)	Weight (kg)	Rotation al speed	Power connection
SP-7740RH	1/4"	129	33	0,480	310	1/4"

VESSEL EUROPE : 8 Avenue Johannes Gutenberg, 78310 Maurepas, FRANCE

Tel : +33 (0)1 69 19 17 42 Fax : +33 (0)1 69 19 42 20 contact@vessel-europe.com www.vessel-europe.com

- **Ultra compact** impact wrench, **lightweight** and **very well sized**, it becomes **essential in automotive, agricultural** and **PL maintenance** for **difficult acces**



Double hammer strike

Model	Training square	Typing type	Optimum torque (N.m.)	Weight (kg)	Rotation al speed	Sound level dB(A)	Consumption (m/min)	Power connection
SP-7147EXA	1/2"	Double hammers	950	0,970	9000	90	0,8	1/4"

- **Shock wrench** 1/2" latest generation
- **Lightweight, ultra compact and powerful** it is the most successful tool in the range of 1/2" impact wrenches
- It has **4 positions** of the setting for power
- A **first position of approach** for a **dynamometer finish**, the whole is controlled with one hand

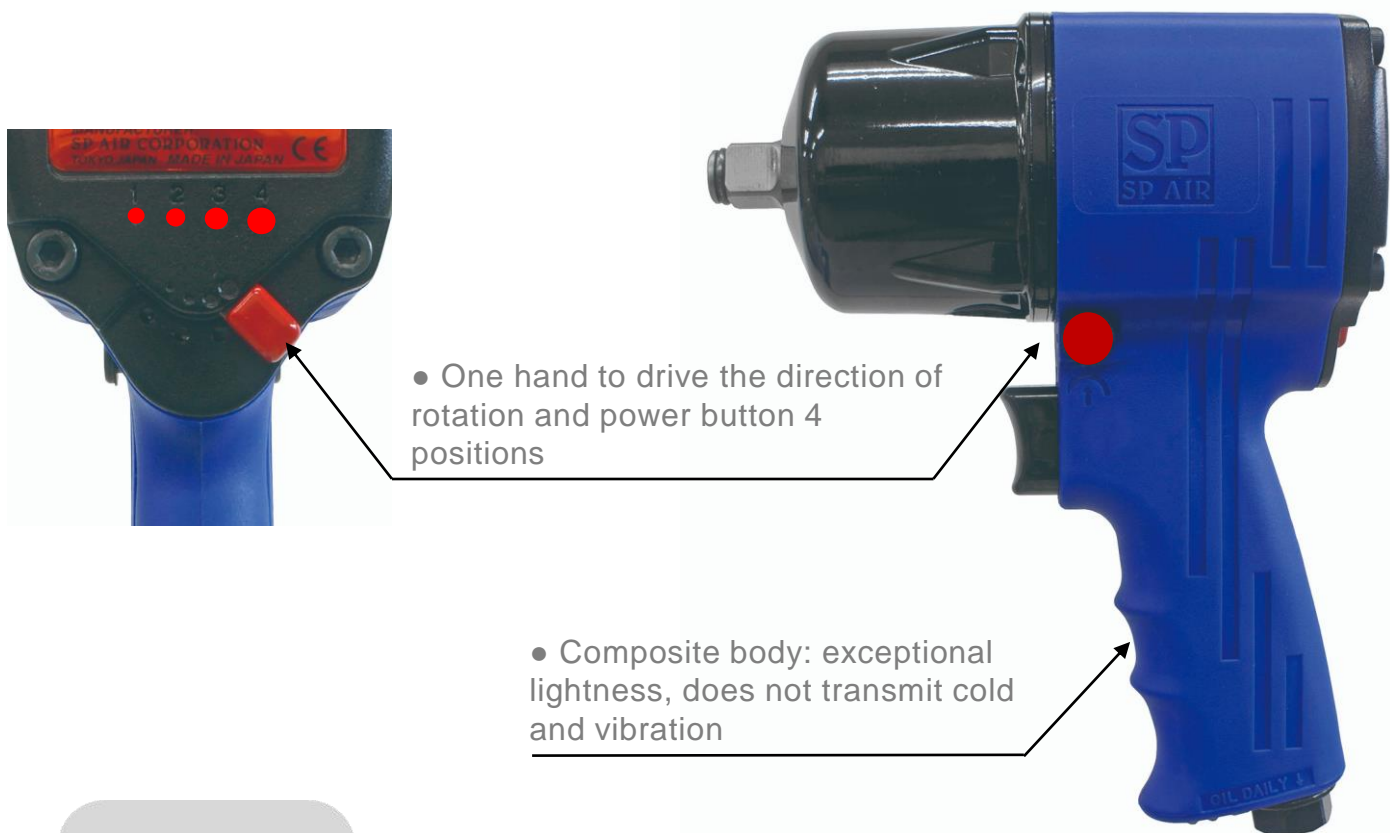

Double hammer strike

Model	Training square	Typing type	Tightening torque (N.m.)	Couple optimum loosening (N.m.)	Weight (kg)	Rotational speed	Consumption (m/min)	Power connection
SP-7144A	1/2"	Double hammers	900	1300	1,78	6200	0,8	1/4"

- Equipped with double hammer strike and composite housing with two-component handle
- Exceptional balance and grip
- Impeccable manufacturing quality, suitable for any type of intensive work

1550 N.m



- Button 4 positions of power adjustment at tightening and full power at loosening



- Fast rotation direction inverter



Double hammer strike



- Composite body: exceptional lightness, does not transmit cold and vibration

Model	Training square	Typing type	Tightening torque (N.m.)	Couple optimum loosening (N.m.)	Weight (kg)	Rotational speed	Consumption (m/min)	Power connection
SP-7140	1/2"	Double marteaux	900	1550	1,78	6200	0,8	1/4"

- Intensive pneumatic saw with rotary motor, exceptional cutting power, its design prevents blade locking

- Sheathing, better grip and does not transmit cold and vibrations

- Cruise control

- Two screws hold the blade

- 360 degree adjustable exhaust



Unlike traditional piston saws, it is built around a rotary engine, which gives it exceptional power and prevents untimely blade blockages even on the hardest materials.

Vibrations are also reduced to a minimum.

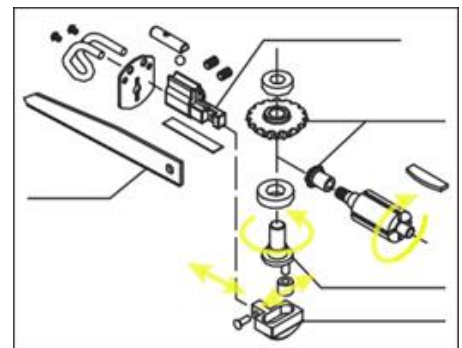

Accessoires	Spécification	
SP-7610-200	Sets of 10 blades 10 teeth/cm HTTS steel and composite	
AS-170	Sets of 10 blades 13 teeth/cm standard steel	
AS-171	Sets of 10 blades 10 teeth/cm for aluminum	

Model	Rotation al speed (RPM)	Race of the blade (mm)	Body diameter (mm)	Length (mm)	Weig ht (kg)	Vibration level (m/s)	Consumption (m/min)	Power connection	Pressure (Bar)
SP-7610	5300	12	40	207	0,6	<2,5	0,5	1/4"	7

- It allows **chamfering or deburring** of steel and aluminum parts
- It has a **precise height adjustment** by threaded ring

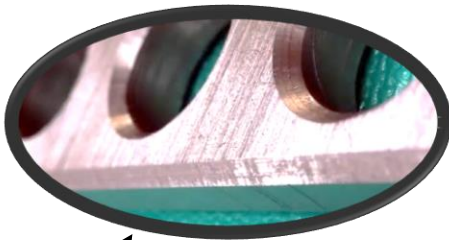

- Example application: straight chamfer or circular chamfer



- Chamfer depth adjustment up to 1.5mm

3 reversible and interchangeable carbide wafers ref. 252-C1,5.

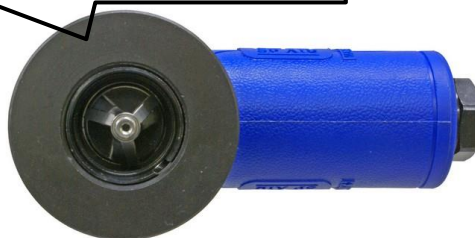

Model	Rotation I speed (RPM)	Height (mm)	Length (mm)	Weight (kg)	Consumption (m/min)	Power connection	Pressure (Bar)
SP-7252F	23000	80	112	0,380	0,2	1/4"	7

- Pneumatic ratchet 1/4" equipped with a **striking system**, it works like an **impact wrench**.
- Unlocking screws, **comfort of use** in difficult access.
- **No return effect** for the user.
- **Much faster** than a conventional ratchet.

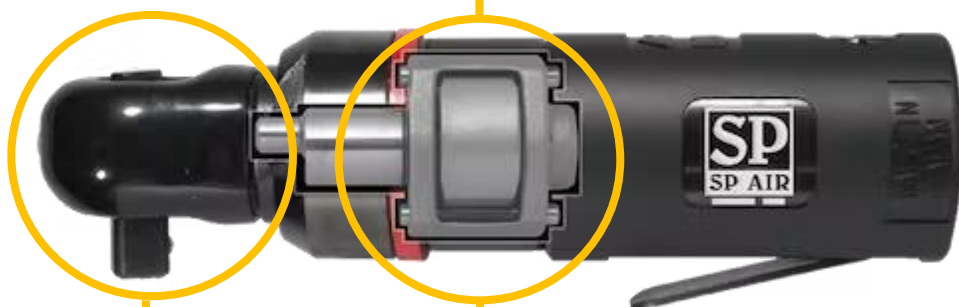

Model	Carré d'entrainement	Couple optimum (N.m)	Rotation speed (Tr/min)	Weigh (kg)	Longueur (mm)	Consommation (m/min)	Raccord d'alimentation	Pressure (Bar)
SP-7720A	1/4"	40	500	0,6	165	0,4	1/4"	7

[illegible]

Tel : +33 (0)1 69 19 17 42 Fax : +33 (0)1 69 19 42 20 contact@vessel-europe.com www.vessel-europe.com

KNOW-HOW BASED ON MORE THAN 100 YEARS OF EXPERIENCE

VESSEL is a leading manufacturer in the field of tooling. The strategy and goals pursued by the founder have gone through the years for more than 100 years, to the present day.

Relentlessly and with dedication, the company is committed to superior quality, new product development and customer satisfaction.



SP AIR is a brand of VESSEL Co., Inc.

VESSEL EUROPE : 8 Avenue Johannes Gutenberg, 78310 Maurepas, FRANCE

Tel : +33 (0)1 69 19 17 42 Fax : +33 (0)1 69 19 42 20 contact@vessel-europe.com www.vessel-europe.com

Sous réserve de modifications et d'erreurs.
Photos et Illustrations non-contractuelles.